

CALLING ALL FUTURE BLOCK LAYERS

THE 2025 CMC JUNIOR BLOCK LAYER COMPETITION

Laying the building blocks of the future starts right here, right now, with the CMC Junior Block Layer Competition — a challenge that builds skills, confidence and careers. With four levels to choose from, the competition is open to students of all ages as well as masonry apprentices. Here's an overview of each competition level and what participants can expect.

BEGINNINER LEVEL

It's not just an introduction to the Concrete Masonry Industry. It's a fun block-laying contest that requires very little skill but inspires young people to learn the trade. The beginner level will give them a sense of accomplishment in laying block while building a desire to move forward in a lucrative and fulfilling career. It will be a timed contest with four 8" Concrete Masonry Units (CMU) laid and judged on industry standards for workmanship. This level is designed for first-time participants and would be well-suited to career days, industry events, plant tours and the like.

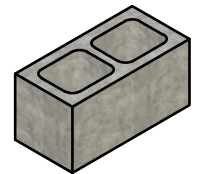

INTERMEDIATE LEVEL

Designed for those that have had some instruction on proper laying techniques for CMU, the intermediate level will help students take the next step on their journey into the masonry trade. This level will also be offered to first-year students in masonry training programs, allowing them to showcase the skills they learned in their first year. Like the beginner level, this will be a timed contest with sixteen 8" CMU laid and judged on industry standards for workmanship. The intermediate contest is designed for participants that started masonry training within the prior year.

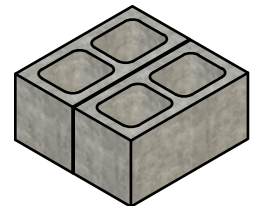

ADVANCED LEVEL

Designed for students that have started their second year of masonry training and those who may have completed the intermediate level, the advanced level of the Junior Block Layer program will be a timed contest with 30 CMU laid and judged on industry standards for workmanship. Also available to those in the apprentice program, this level is ideal for masonry pathway completers, working apprentices, and second-year masonry students.

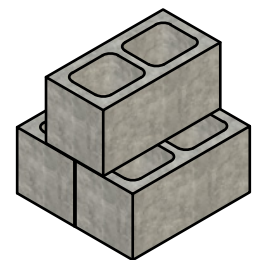

TEAM LEVEL

Open to students at any stage of the Junior Block Layer program, this level is a team-based contest in which groups of three students collaborate to construct a CMU wall. Participants may perform any necessary tasks, including laying block, tending, jointing, etc. Meant to reflect a real-world jobsite, the team level event will be a timed contest with 30 six 8" CMU laid and judged on industry standards for workmanship.

